

## **APPENDIX D**

### **Definition of Study Area**

**D1 - Additional Maps**

## D1 - Additional Maps

### D1.1 - Cadastral for the Proposed Land Parcel to be Developed

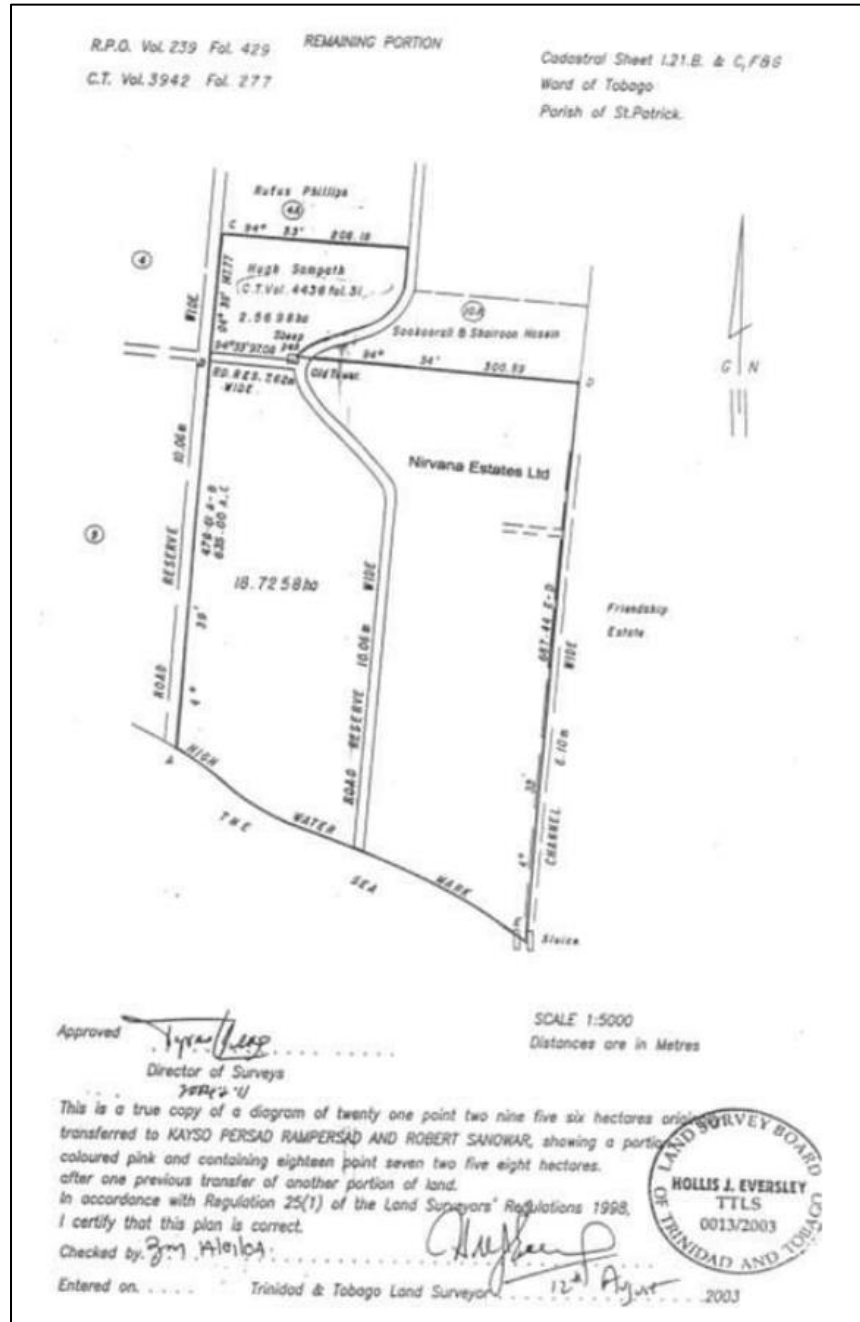

**D1.2 – Far field (5km) impact zonation showing Type A and Type B roads considered in the EIA. Kilgwyn Bay, South-West, Tobago**

